

UX200

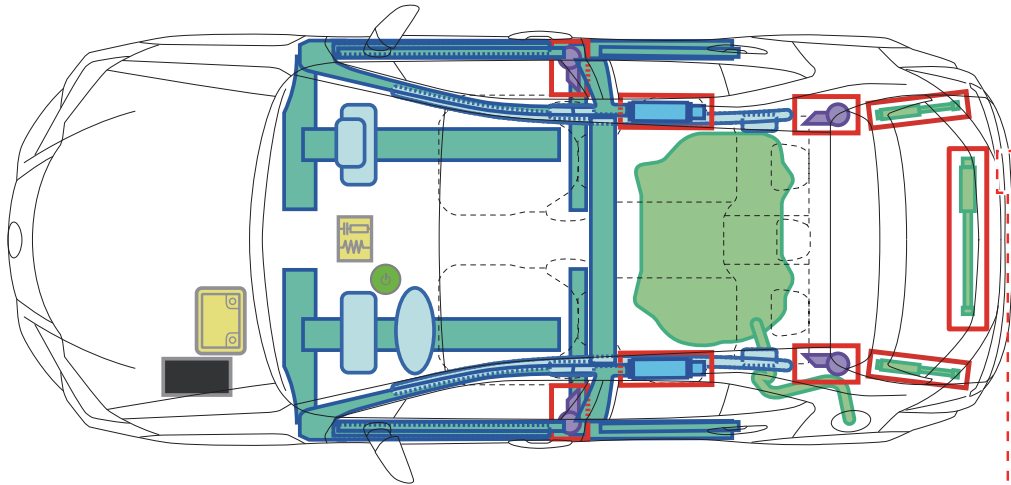







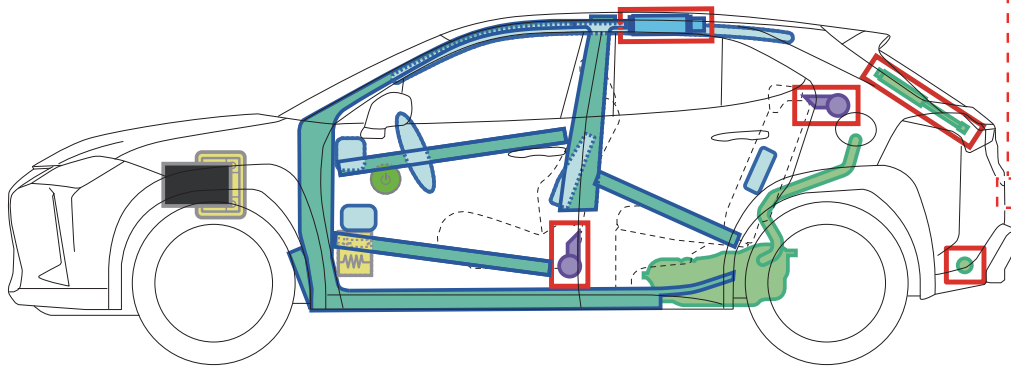

ZA1 (EU,M)

ab 10.2018



UX 200



	Zündschalter		Sicherungskasten		12V Batterie
	Airbag		Gasgenerator		Kraftstofftank
	Gasdruckdämpfer		Gurtstraffer		Karosserieverstärkung
	Steuergerät				

Fahrzeug ausser Betrieb setzen

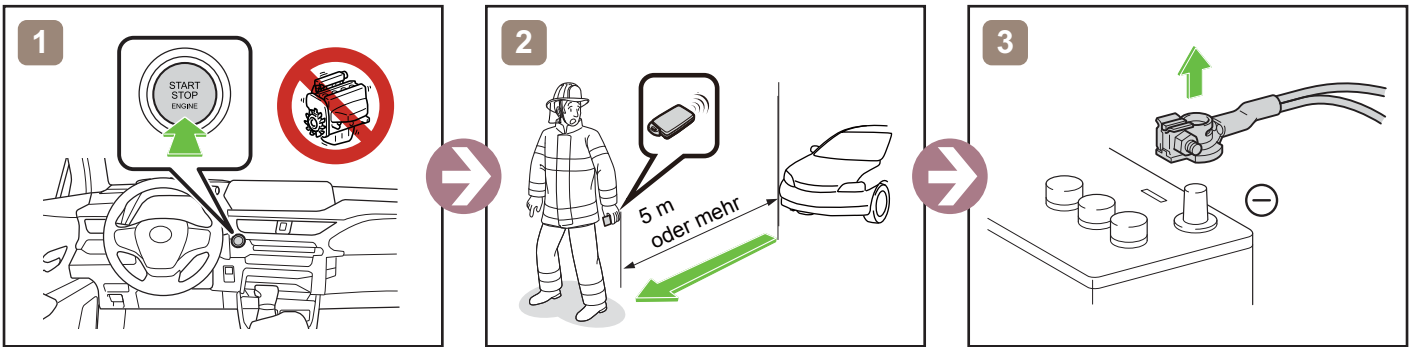

oder

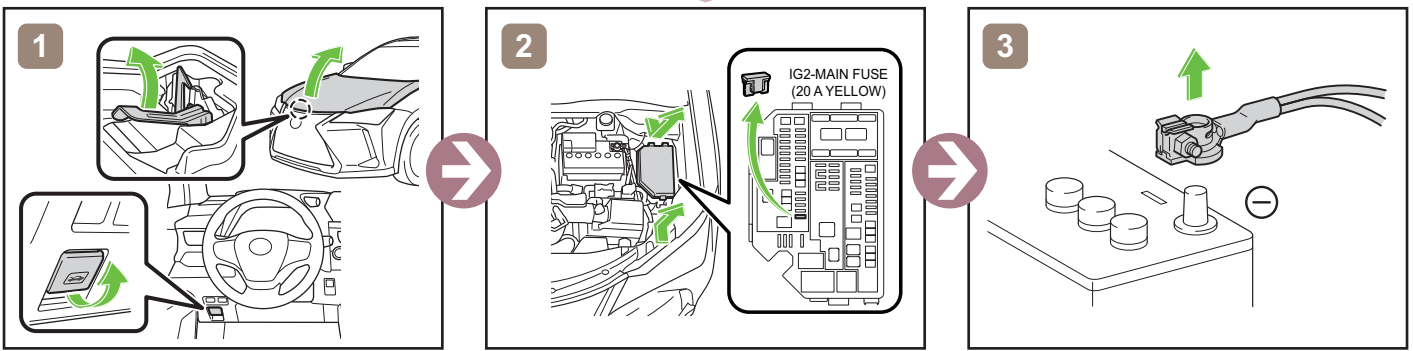

Zugang 12V-Batterie

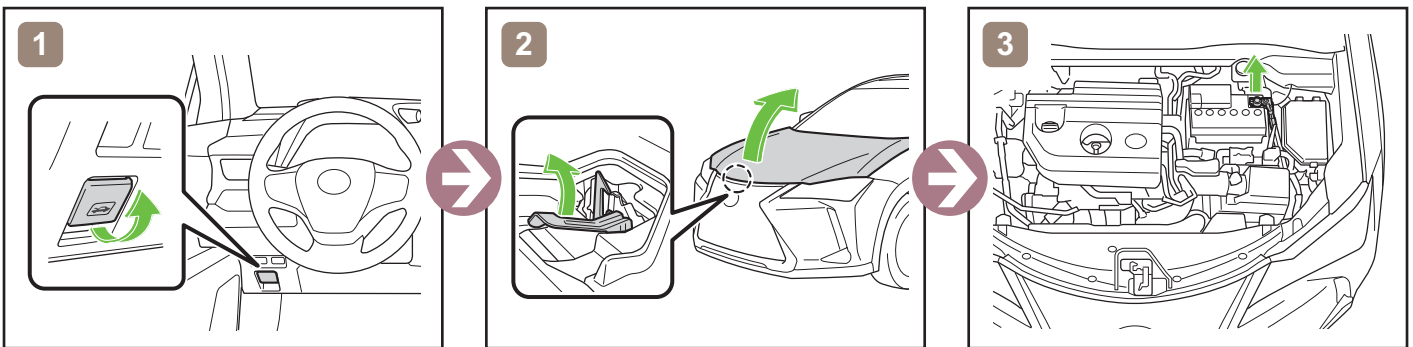

Hinweise zum Transport

